

MOTO GUZZI V7 III STONE, CARBON, ROUGH SISSYBAR / LUGGAGE RACKS MOUNTING INSTRUCTIONS

(1) Sideplates

Front part: Fix the side plate of the kit on its front part to the anchor of the shock absorber, with the **M6x20** screw included in the kit (**Image 1**).

Rear: - Fix the auxiliary plate of the kit to the anchor indicated in **image 2**, located under the seat. **Important! Keep the cap bushings placed on the screws, by the inside of the fenders.**

On the free end of the auxiliary plate, fix the back part of the side plate of the kit, placing the **Ø20x10** bushing between the plate and the side plate. Join the assembly with the **M8x25** screw, the **M8** self-locking nut and flat washers included in the kit (**Image 3**).

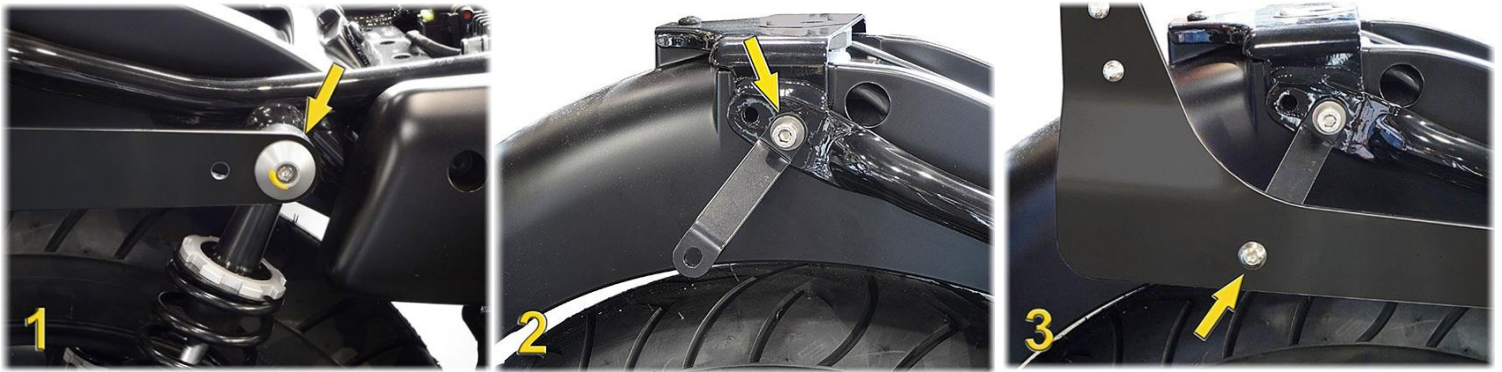

Sissybar uprights – luggage rack arch

Fix the sissybar upright (high or low), or in case of a luggage rack or luggage rack **TC**, the luggage rack arch to the sideplates **SPAAN** with the four screws **M6x20**. Put **M6** nuts from the inside (**Image 4**).



(2) Rack

For installation in luggage racks kits or in any sissybars of our brand **SPAAN**. We must place it the inside of the sissybar uprights or the small arch and fix the assembly with **4** screws **M6x20** and nuts **M6** included in the kit. **In all LUGGAGE RACKS is required to mount the small arch**, to give more rigidity to the assembly.

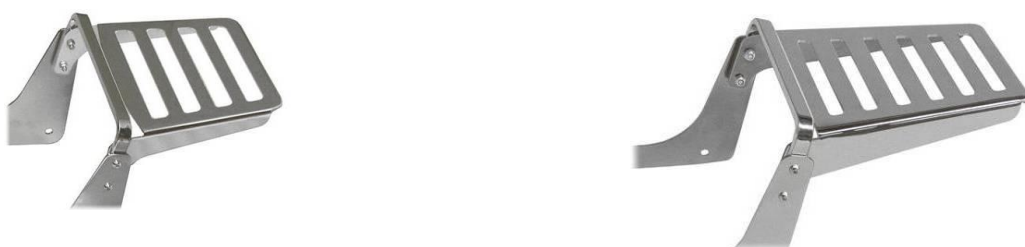

(3) Pad

Join the set with four screws **M5x10** that accompany the kit. (In the back of the pad is marked with four holes in the fabric the position of the threads).

